

## READ THIS!

### Before installing please check these facts carefully:

The wall must be even and smooth. For uneven surfaces installation with screws is recommended.

Push each corner of the panel firmly against the wall. Make sure that the adhesive tapes have attached tightly against the wall also from the edges.

Before installing clean the wall properly from dust.

The full bond of the adhesive is reached in 24 hours.

## MAINTENANCE

### Maintenance of Soften acoustic panels

Soften acoustic panels are easy to maintain. They can be vacuum cleaned with a furniture nozzle. The panels can be removed for cleaning.

The wall-side of the adhesive tape will remain to the wall while cleaning. Stains can be cleaned with damp cloth.

Mild cleanser liquid meant for synthetic fibers is suitable.

## INSTALLATION MAINTENANCE

**soften**<sup>®</sup>  
ACOUSTIC SOLUTIONS

Easy to maintain:  
only 5 steps!

Suitable on all wall surfaces

The panels can also be installed with screws.

A pencil and a measuring tape is all you need!



## INSTALLATION

1

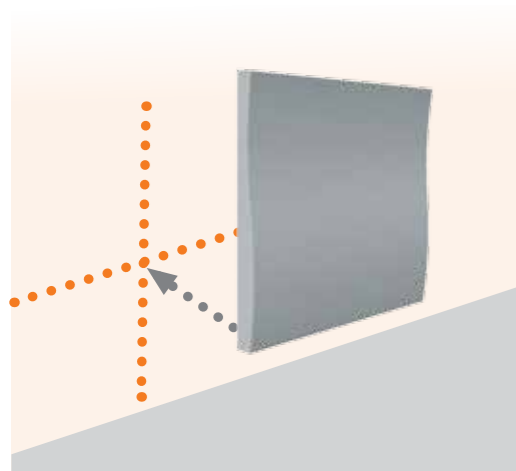

Prepare the layout for your panels. Mark the horizontal and vertical lines to help align the panels.

2

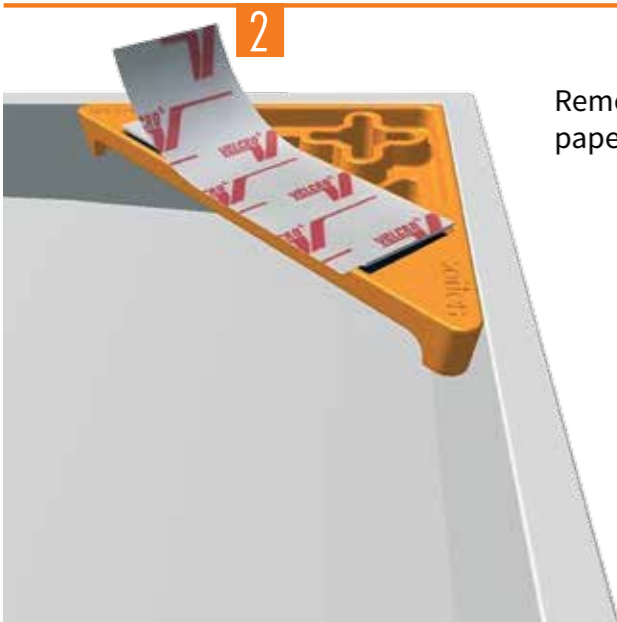

Remove the protective papers of the tape.

3

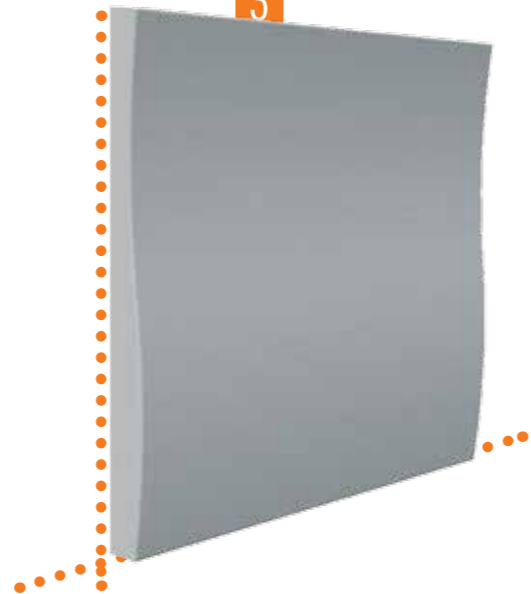

Align the first panel with horizontal and vertical lines and press it firmly to the wall for 5-10 seconds..

4

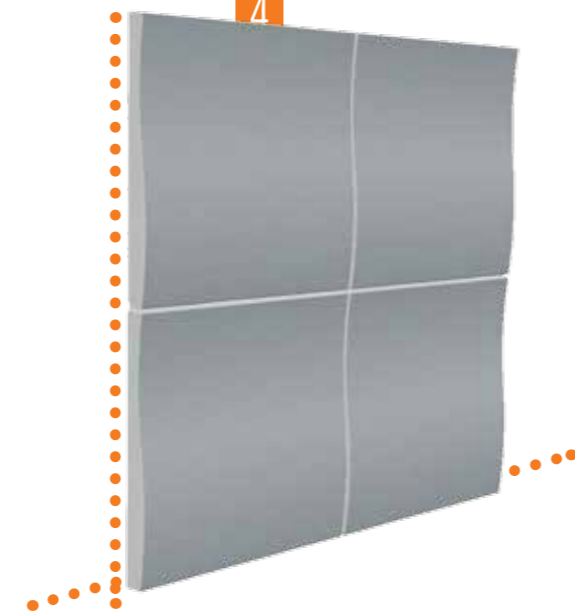

Install the rest of the panels.  
A gap of 0-5 cm can be left between the panels without changing the acoustic effect.

## INSTALLATION

5

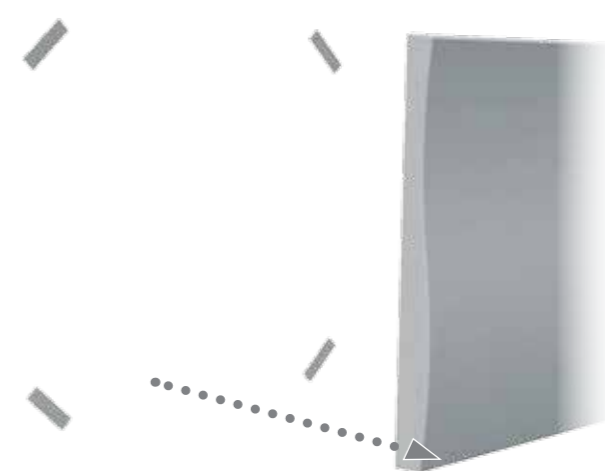

Take the panels off one by one. Press the wall tapes firmly against the wall. Minimum temperature +15 degrees.

